

## STATION

# DirectDrive

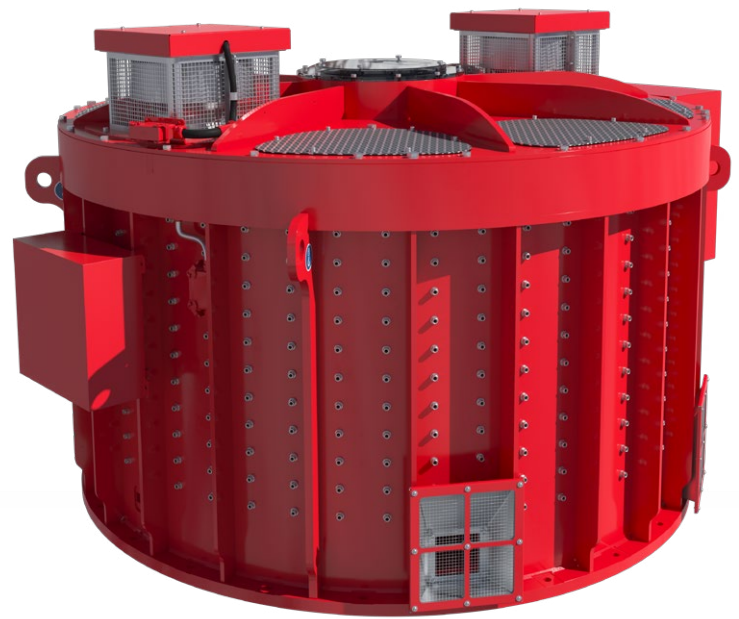

A clean, silent drive that is part of an eco-responsible approach: lower energy consumption, no fossil fuel consumption, less noise pollution, and more safety.



**Clean and silent** drive

---

**Simplified** maintenance

---

360+ installations fitted worldwide since 1999

---

7 models available

---

**-15 A-weighted decibels** (dBA)\*

---

Energy savings of **up to 8%**

---

**Up to 3 tonnes** of CO2 avoided\*

---

Possibility of recovering heat from variable speed drives

DirectDrive is a direct drive technology for drive sheaves with no intermediate gearbox.

Ropeway operators worldwide love its excellent performance and environmental benefits.



Environmental Performance



Product Performance



Compatible with new and existing ropeways

\*compared with an equivalent chairlift equipped with a geared motor

## STATION

# DirectDrive

### FEATURES & BENEFITS



#### › Range and performance

- Wide range of 7 models to suit the needs of each installation (torque ranges from 144 to 630 kNm)
- Works without oil and fossil fuels

#### › Availability and safety

- Intrinsic redundancy (coolers, segments) for a very high level of availability and safety
  - The motor is kept at temperature by 2 coolers. If one breaks down, the second will keep the installation running
  - The motor has up to 8 rotor and stator segments. If one of them fails, the motor operates at reduced power, ensuring passengers are transported in complete safety

#### › Maintenance and staff safety

- Less maintenance as no gearbox
- Easy access to components
- No visible rotating parts, even when segments need replacing
- Quick segment replacement

### ENVIRONMENT

- › 100 % European **design and manufacture** by the HTI Group

#### › Transportation

No need to return items to the factory for a revision throughout its entire life cycle: significant transport-related energy savings

#### › Use

- 5% reduction in electricity consumption compared with a geared motor = 3 tonnes less CO<sub>2</sub> per year for one chairlift
- 15 dB(A) reduction in noise emissions
- No gear oil = no need for oil change, lower risk of environmental contamination and lower risk of fire
- Possibility of recovering heat from variable speed drives meaning you can heat an adjacent room

